



Section 31A file reference number:

31A/1/90/003

THE HIGHWAYS ACT 1980 –
SECTION 31(6)

**DEPOSIT OF MAPS, STATEMENTS AND STATUTORY
DECLARATIONS SUMMARY SHEET**

Title and/or description of land referred to: Westlaw Wood 1, Ebchester

District: Derwentside

Parish/ward: Consett

Ordnance Survey grid reference (6 figure): NZ 096 543

Land Post Code: DH8 0

Name and address of person who deposited the statement and map

Name: Liz Strange, 52 South Terrace, Esh Winning, Durham

Landowner/agent/tenant for life/trustees (delete as applicable)

The Woodland Trust

Address: Autumn Park, Dysart Road, Grantham, Lincolnshire.

Post code: NG31 6LL

Date deposit of map and statement received: 05/09/1990

Date/s of statutory declaration: 02/09/1996, 18/02/2002, 26/04/2010

Date current statutory declaration expires: 26/04/2020

Notes:

Patrons:

Dame Sylvia Crowe, D.B.E.; The Right Honourable Lord Denning;
Dame Elisabeth Frink, D.B.E., R.A.; P. F. Garthwaite Esq., O.B.E.;
Sir Charles Groves, C.B.E.; R. Hammond Innes, C.B.E.;
Professor W. G. Hoskins, C.B.E.; The Earl of Lichfield;
Miss Moura Lympny, C.B.E.; E. M. Nicholson Esq., C.B., C.V.O.

Council of Management:

K. Watkins, O.B.E. (Chairman); O. G. Rossetti, M.A.; S. Edgcumbe, J.P., F.C.A.;
C. P. Wright, M.Sc., A.R.I.C.S., A.L.I.; R. H. Trafford, M.A.;
D. G. Waddams, F.C.C.A.; T. H. White, F.R.I.C.S., F.A.A.V.;
T. W. Wright, B.Sc. (For.), Ph.D.; D. H. Marks, M.I.P.A.



Executive Director: John D. James

If no telephone response at the number below
please ring (0476) 74297

Please reply to:

Ms LIZ STRANGE
52 SOUTH TERRACE
ESH WINNING
Co DURHAM
DH7 9PS
TEL: (091) 373 5851

Our Ref: EAS/MI
31 August 1990

Director of the Environment
Durham County Council
County Hall
Durham
DH1 5UL

Dear Sir,

HIGHWAYS ACT 1980 - Section 31(6)

WESTLAW WOOD, EBCHESTER

The Woodland Trust, a company limited by guarantee and registered charity no. 294344, of Autumn Park, Dysart Road, Grantham, Lincolnshire, freehold owners of the property known as Westlaw Wood which is shown outlined in red on the attached plan, hereby gives notice in accordance with Section 31 (6) of the Highways Act 1980 that there are no ways over the land shown on the attached plan as being owned by the Woodland Trust which have been dedicated as public highways.

Yours faithfully



Liz Strange
Woodland Operations, authorised to sign on behalf of the
Woodland Trust.

1:2500

(scale) map of

(year) with the

The Woodland Trust Date 21.11.89
Autumn Park, Grantham, Lincs NG31 6LL

The Woodland Trust Date 21.11.89
Autumn Park, Grantham, Lincs NG31 6LL

Autumn Park, Grantham, Lincs NG31 6LL

G.R. NZ 096543

the
woodland
trust



approx 6.8 acres.

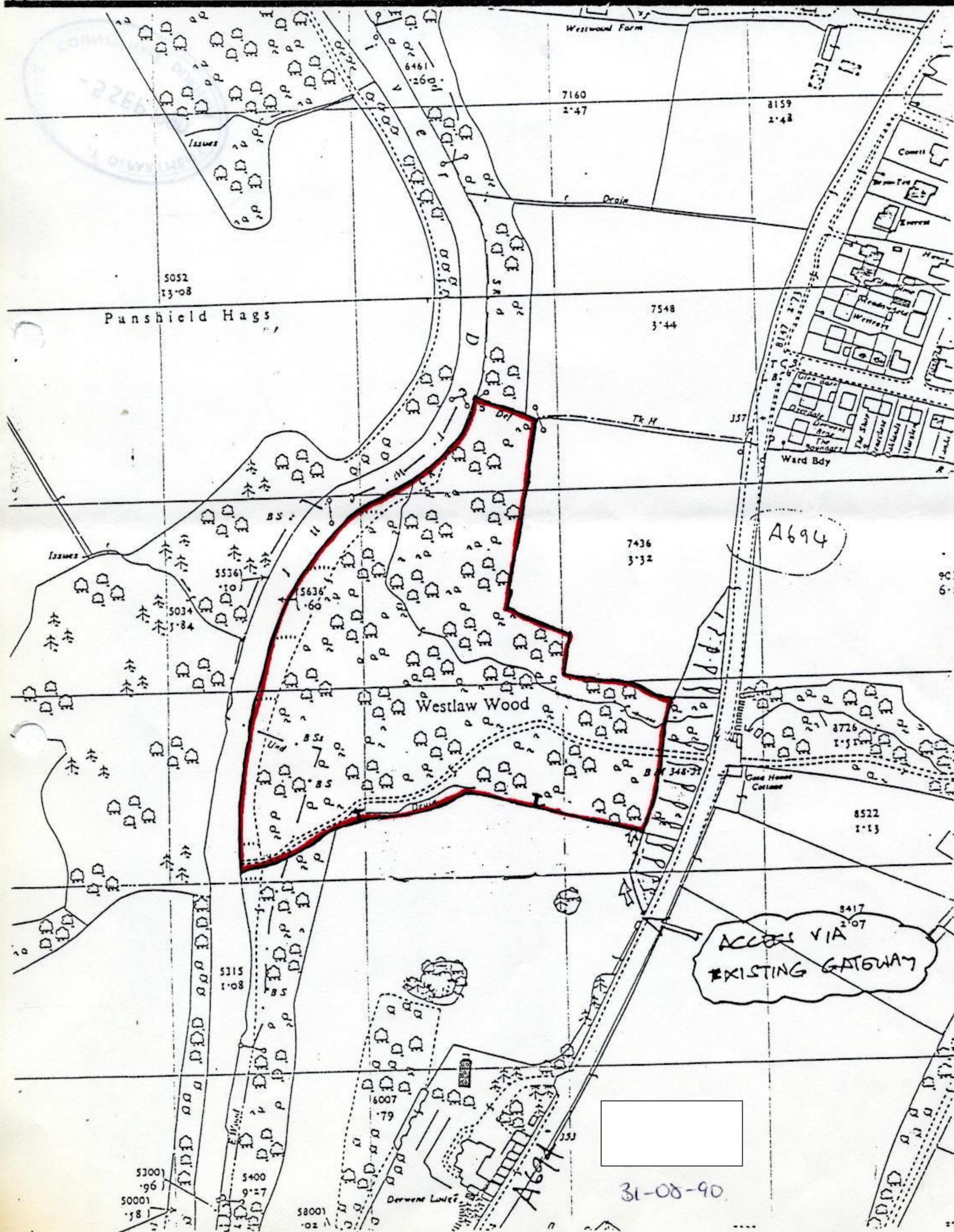

DECLARATION

UNDER SECTION 31 (6) HIGHWAYS ACT, 1980

I, Graham David Bradley
of The Woodland Trust, Autumn Park,
Dysart Road, Grantham, Lincolnshire, NG31 6LL
do solemnly and sincerely declare as follows:-

1. On the 31 August 1990 my colleague, Liz Strange of The Woodland Trust deposited a map of land located at Westlaw Wood, Ebchester with the County Council of Durham, together with a plan attached marked GB.1 and a statement denying that any ways over that land had been dedicated to the public.
2. Since such deposit and statement, no ways have been dedicated by The Woodland Trust for the use of the public as highways.

AND I make this solemn declaration conscientiously believing the same to be true and by virtue of the Statutory Declarations Act 1835.

DECLARED by the above named

at

27/31 Northgate
Sleaford

in the County of Lincolnshire

on the

2/11/96

Before me Stephen Swift

Solicitor

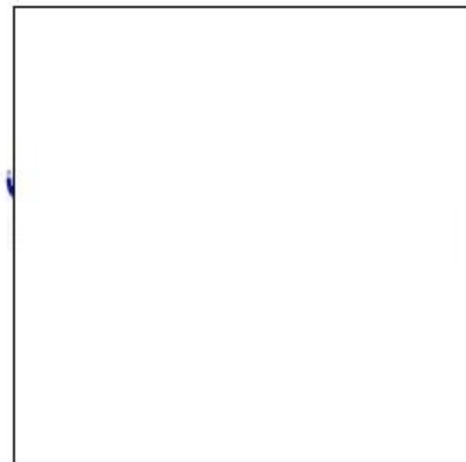

Reproduced from the Ordnance Survey's
 1:2500 (scale) map of
 (year) with the
 permission of the Controller of
 Her Majesty's Stationery Office,
 Crown copyright reserved.
 The Woodland Trust Date 21.11.89
 Autumn Park, Grantham, Lincs NG31 6LL

Westlaw Wood.

the
 woodland
 trust



approx 6.8 acres

G.R. NZ 096543

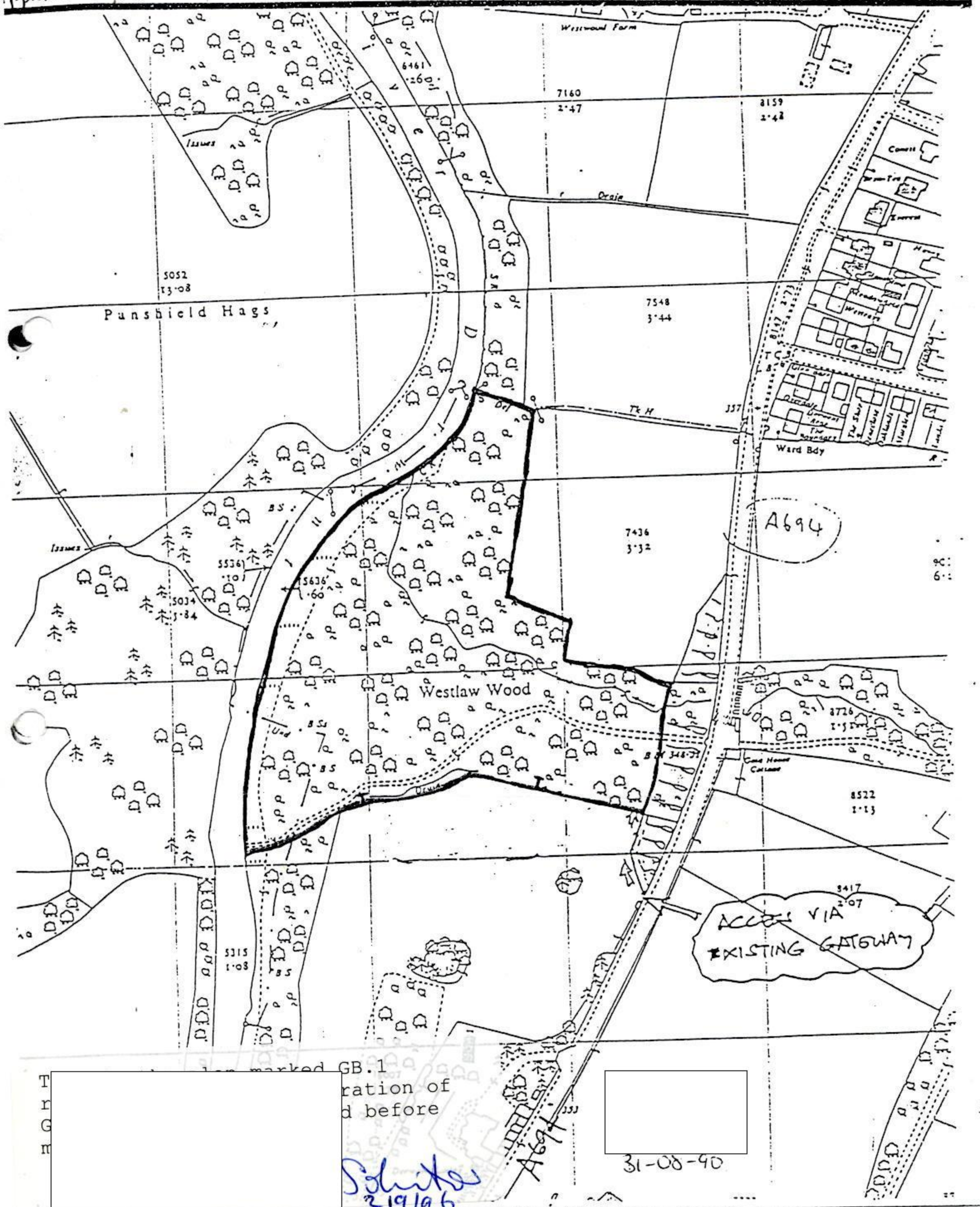

STATUTORY DECLARATION

HIGHWAYS ACT 1980 SECTION 31 (6)

I LOUISE SMITH DO SOLEMNLY AND SINCERELY DECLARE as follows:

1. The Woodland Trust, a company limited by guarantee and registered charity no. 294344, is and has been since 23 March 1990 the owner of the land known as Westlaw Wood, Ebchester, Durham and since 9 September 1994 the owner of the land known as Westlaw Wood Extension, Ebchester, Durham particularly delineated on the plan accompanying this declaration and thereon edged red.
2. On the 31st of August 1990 the Woodland Trust deposited with Durham County Council, being the appropriate Council, a statement accompanied by a plan delineating our property by red edging which stated that no ways had been dedicated as highways over our property.
3. On the 14th day of August 1996 my predecessor in title Graham Bradley deposited with Durham County Council, being the appropriate Council, a statutory declaration dated 14 August 1996 stating that no ways had been dedicated as highways since the deposit of the statement referred to in 2 above.
4. No ways have been dedicated over the land edged red on the plan accompanying this declaration since the date of the statutory declaration referred to in 3 above and at the present time the Woodland Trust has no intention of dedicating any public rights of way over its property.

AND I MAKE this solemn declaration on the 18th day of February, 2002 conscientiously believing it to be true and by virtue of the Statutory Declarations Act 1835.

Declared at: Mills & Reeve, Francis House, 112 Hills Road, Cambridge, CB2 1PH

.....

Louise Smith

Assistant Land Agent authorised to sign on behalf of the Woodland Trust

Before me, Michael Aubrey, Solicitor

.....

Ordnance Survey

Superplan Data

Site-centred

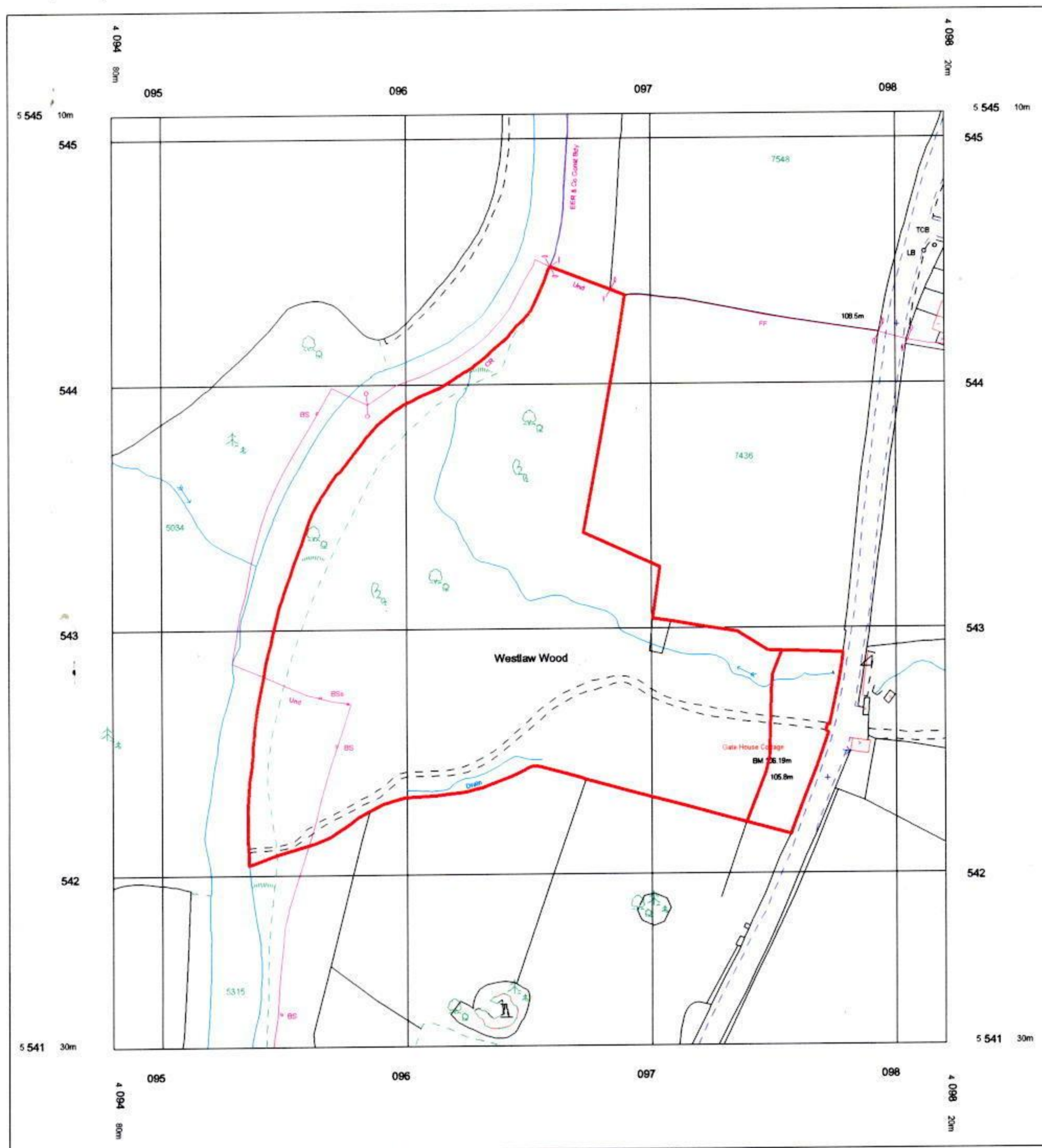

Produced 10 Jul 2001 from Ordnance Survey digital data and incorporating surveyed revision available at this date.

© Crown Copyright

Reproduction in whole or in part is prohibited without the prior permission of Ordnance Survey.

Ordnance Survey and Superplan Data are registered trade marks of Ordnance Survey the national mapping agency of Great Britain

This Superplan product does not contain all recorded map information.

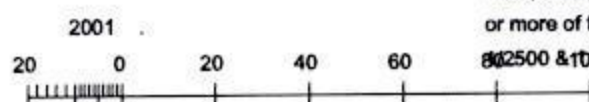

Solicitor

This product contains data surveyed at one or more of the following scales: 1:2500 & 1:100000.

National Grid sheet reference of this Superplan:

The representation of a path is no evidence of

Heights are given in metres above Mean Sea Level Datum.

The alignment of tunnels

Centre Coordinates:

Supplied by:

Serial Number:

Westlaw Wood



WOODLAND TRUST

Wood No:

Cost Centre:

Scale: 1:2500

Author: LS

Date: 12/02/02

Reproduced from Ordnance Survey digital data © Crown Copyright. AL559385

This is the plan that accompanies the Statutory Declaration dated 18/02/02

STATUTORY DECLARATION

HIGHWAYS ACT 1980 SECTION 31 (6)

I AVERIL HAROLD DO SOLEMNLY AND SINCERELY DECLARE as follows:

1. The Woodland Trust, a company limited by guarantee and registered charity no. 294344, is and has been since 23 March 1990 the owner of the land known as Westlaw Wood, Ebchester more particularly delineated on the plan accompanying this declaration and thereon edged red.
2. On the day of 20 February 2002 a statutory declaration was deposited with Durham County Council, being the appropriate Council, stating that no additional ways had been dedicated since the deposit of the statement 31 August 1990.
3. No additional ways have been dedicated over the land edged red on the plan accompanying this declaration since the statutory declaration referred to in 2 above and at the present time the Woodland Trust has no intention of dedicating any more public rights of way over its property.

AND I MAKE this solemn declaration on the 26 day of April, 2010 conscientiously believing it to be true and by virtue of the Statutory Declarations Act 1835.

Declared at: The Woodland Trust, Autumn Park, Dysart Road, Grantham, Lincolnshire, NG31 6LL

[Redacted Signature Box]

.....
Averil Harold (Mrs)

Legal Officer authorised to sign on behalf of the Woodland Trust

Before me, Nicola Briggs, Solicitor, of Kingswell Watts, Solicitors, Dewsbury, West Yorkshire

[Redacted Signature Box]

Westlaw Wood & Westlaw Wood ext



Wood Refs: 00415 & 00683
Grid Refs: NZ096543 & NZ097542

Scale: 1:2500

Author: AMH

Date: 09/02/2010

Reproduced from Ordnance
Survey digital data
© Crown Copyright. 100017626

Statutory Declaration Legend



Woodland Trust Boundary



Footpath

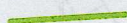

Bridleway



Byway Open to All Traffic



Restricted Byway



Other legal route

Panshipid Hags

Issues

BS

BS

BS

BS

T Rock

E Wood

Park Wood

Derwent Lodge

A 694

Westlaw Wood

Gate House Cottage

105.8m

108.5m

107.6m

TCB

LB

FB

Pipeline

UA & CP Bdy
Derwent