



Making a difference where you live

Section 31A file reference number:

31A/1/98/016

THE HIGHWAYS ACT 1980 –
SECTION 31(6)

**DEPOSIT OF MAPS, STATEMENTS AND STATUTORY
DECLARATIONS SUMMARY SHEET**

Title and/or description of land referred to: Delves Lane Industrial Estate, Consett

District: Derwentside

Parish/ward: Consett

Ordnance Survey grid reference (6 figure): NZ 117 490

Land Post Code: DH8 7

Name and address of person who deposited the statement and map

Name: R.J. Humphies MP Bonser

Landowner/agent/tenant for life/trustees (delete as applicable)

Address:	Durham County Council	Derwentside District Council
	County Hall	Civic Centre, Medomsley Road,
	Durham	Consett, Co. Durham

Post code:	DH1 5UL	DH8 5JA
-------------------	---------	---------

Date deposit of map and statement received: 20/08/99

Date/s of statutory declaration:

Date current statutory declaration expires: 20/08/09

Notes:

**DEPOSIT OF STATEMENT AND PLAN
SECTION 31(6) OF THE HIGHWAYS ACT 1980**

TO: The Director of Environment and Technical Services
Durham County Council
County Hall
Durham

1. We are and have been since 4 July 1962 the owners within the meaning of the above section of all the land known as Delves Lane Industrial Estate, more particularly delineated on the plan accompanying this statement and thereon edged red.
2. The aforementioned land lies in the Community of Delves Lane near Consett, County Durham.
3. The ways coloured brown have been dedicated as highways with vehicular status.
4. No other ways over the land have been dedicated as highways.
5. The deposit shall comprise this statement and accompanying plan.

Signed (County Secretary and Solicitor on behalf of Durham County Council)	Signed (On behalf of Derwentside District Council)
Name <u>R. J. HUMPHRIES</u>	Name <u>M.P. Boushel</u>
Address <u>COUNTY HALL</u> <u>DURHAM</u> <u>DH1 5UL</u>	Address <u>CIVIC CENTRE</u> <u>MEDONSLEY ROAD CONSETT</u> <u>6. DURHAM DH8 5JA</u>
Date <u>29th JULY 1999</u>	Date <u>3rd August 1999</u>
Signed (Witness) 	Signed (Witness)
Name (of Witness) <u>ANN SWAINSTON</u>	Name (of Witness) <u>RICHARD HURST</u>
Address <u>COUNTY HALL</u> <u>DURHAM</u> <u>DH1 5UL</u>	Address <u>CIVIC CENTRE</u> <u>MEDONSLEY ROAD</u> <u>CONSETT CO DURHAM</u>
Date <u>29th JULY 1999</u>	Date <u>3/8/99</u>
Occupation <u>LOCAL GOVERNMENT</u> <u>OFFICER</u>	Occupation <u>Chartered Surveyor</u>

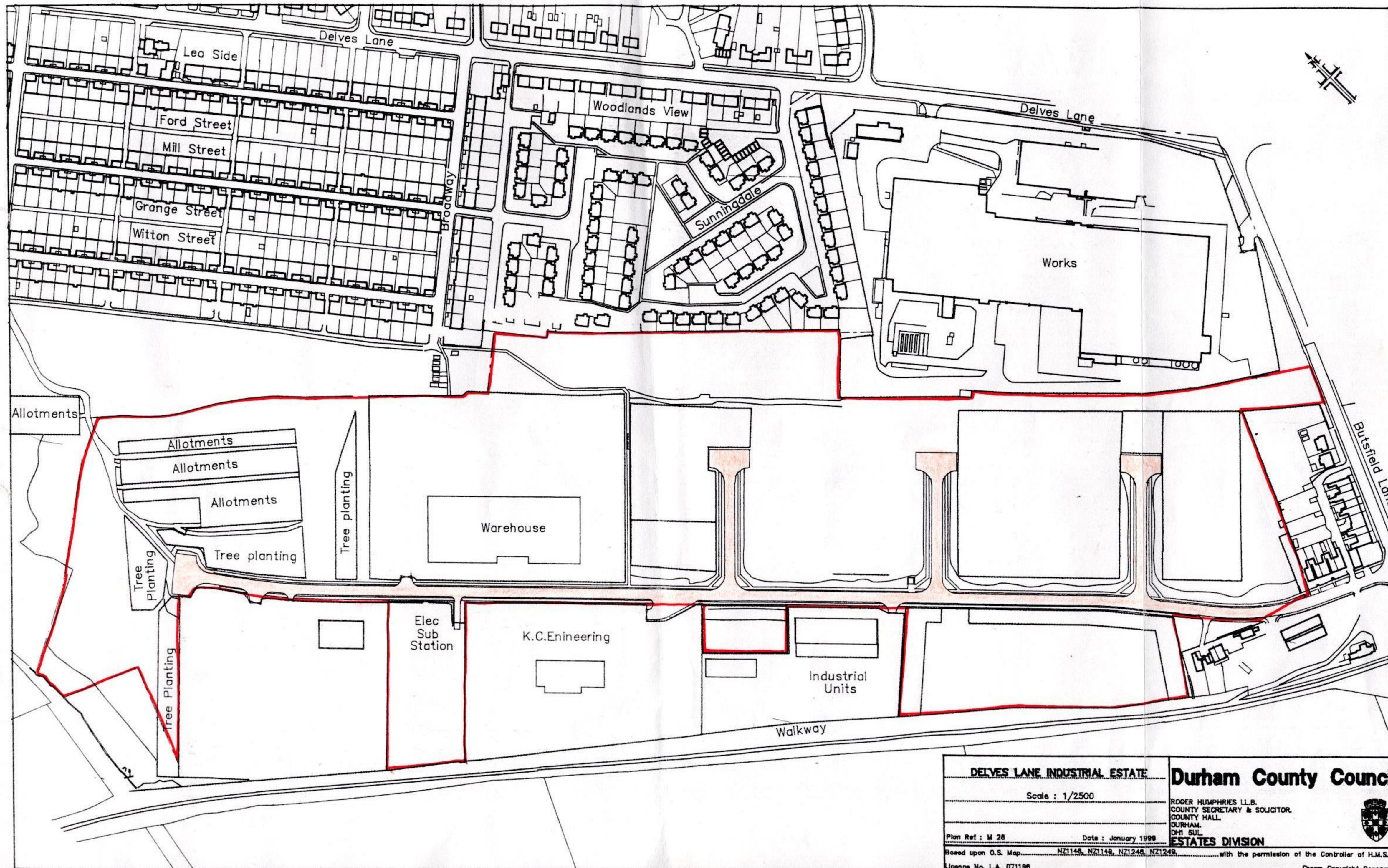

DELVES LANE INDUSTRIAL ESTATE

Scale : 1/2500

Plan Ref : M 28

Date : January 1988

Based upon O.S. Map NZ1148, NZ1149, NZ1248, NZ1249

License No. L.A. 071196

Durham County Council

ROGER HUMPHRIES LL.B.
COUNTY SECRETARY & SOLICITOR
COUNTY HALL
DURHAM
DH1 5UL
ESTATES DIVISION



with the permission of the Controller of H.M.S.O.

© Crown Copyright Reserved.